

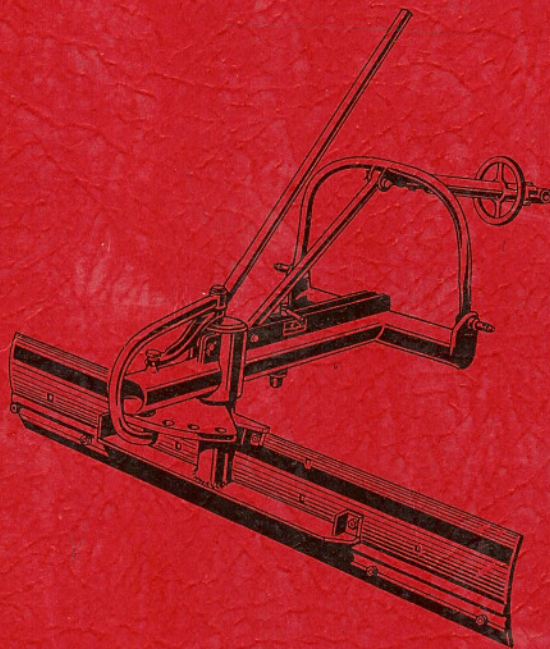

DANUSER

ALL PURPOSE BLADE

MASTER PARTS BOOK



JULY 1952

DEARBORN MOTORS CORPORATION - BIRMINGHAM, MICHIGAN

www.ntractorclub.com

DANUSER *All Purpose Blade*

MASTER PARTS BOOK

PREFACE

The purpose of this Parts Book is to present, in convenient group sequence, a listing of all parts which may be required to service the Danuser All Purpose Blade.

JULY, 1952

**DEARBORN MOTORS CORPORATION
2500 EAST MAPLE ROAD, BIRMINGHAM, MICHIGAN**

COPYRIGHT 1952, DEARBORN MOTORS CORPORATION, BIRMINGHAM, MICHIGAN

DANUSER *All Purpose Blade*

GENERAL INFORMATION

To insure simplicity and in keeping with a uniform system of parts book preparation, this book has been compiled and arranged according to seven major divisions as follows:

GENERAL INFORMATION - This division contains an explanation of the features of this catalog plus instructions and examples as to how the catalog may be most efficiently used.

MODEL INDEX - This division contains a list of all models covered by this Parts Book.

GROUP INDEX - This division contains a list of the sub-groups into which the Parts List has been separated, together with the page number on which each of these groups appear.

ILLUSTRATION INDEX - This division lists the figure numbers, titles and page numbers on which each illustration may be found.

ALPHABETICAL INDEX - This division contains an alphabetical listing of all parts together with the Group numbers in which each part may be found.

PARTS LIST - This division, which makes up the body of the catalog, lists all the parts which are available for service replacement, and indicates the part number and name of each, as well as the quantity required per unit.

To simplify the locating of parts, this division has been broken down into sub-groups as listed in the Group Index on Page 3. For example, Group 1 covers the Danuser All Purpose Blade and has been broken down into three sub-groups as follows:

- Group 1-1 Frame Assembly
- Group 1-2 Pitch Control Assembly
- Group 1-3 Moldboard and Blade Assembly

To further simplify the locating of parts in the Parts List and to insure positive identification of the part or parts required an Exploded View Illustration has been placed at the beginning of each sub-group. These illustrations are actual photographs of the various assemblies, sub-assemblies and attaching parts listed in each sub-group. Each part in every illustration has been given an item number which ties it up directly with its respective part number in the Parts List.

NUMERICAL INDEX - This division contains a list of all parts in numerical order, together their part name and page number on which each part may be found.

INSTRUCTIONS FOR LOCATING PARTS WITHIN THIS PARTS BOOK

By using the various indexes, illustrations, and the grouping system employed in this book any part may be easily located. For example:

1. If only the name or description is known -
 - a. Turn to the Alphabetical Index and locate the part by description of name in alphabetical sequence.
 - b. Turn to the Group number listed and locate the desired part in the Parts List.
2. If only the function of the part is known -
 - a. Turn to the Group Index or the model illustration in the front of the book and ascertain the group in which the part is most likely to appear in the Parts List.
 - b. Turn to the indicated group and refer to the illustration preceding that group and locate the desired part on that illustration.
 - c. Ascertain the item number of the part desired and locate the item number on the immediately following Parts List by using the illustration reference column.
3. If only the part number is known -
 - a. Turn to the Numerical Index and locate the part in numerical sequence.
 - b. Turn to the page number listed and locate the desired part in the Parts List.

It is felt that by careful study of the instructions outlined above and then by putting them to practice when using the book that you will find this Parts Book extremely simple to use as well as concise and complete in every way.

MODEL INDEX

<u>Model No.</u>	<u>Description</u>
19-16	Danuser All Purpose Blade 6 Foot Moldboard and Blade 7 Hole Angle Adjustment
19-34	Danuser All Purpose Blade 8 Foot Moldboard and Blade 7 Hole Angle Adjustment
19-50	Danuser All Purpose Blade 6 Foot Moldboard and Blade 9 Hole Angle Adjustment
19-51	Danuser All Purpose Blade 8 Foot Moldboard and Blade 9 Hole Angle Adjustment

GROUP INDEX

<u>Group No.</u>	<u>Name</u>	<u>Page No.</u>
1	DANUSER ALL PURPOSE BLADE.....	7
1-1	Frame Assembly.....	7
1-2	Pitch Control Assembly.....	8
1-3	Moldboard and Blade Assembly.....	9

ILLUSTRATION INDEX

<u>Figure No.</u>	<u>Name</u>	<u>Page No.</u>
1	Danuser All Purpose Blade.....	5
2	Frame Assembly.....	6
3	Pitch Control Assembly.....	8
4	Moldboard and Blade Assembly.....	9

DANUSER *All Purpose Blade*

ALPHABETICAL INDEX

Part Name	Group No.
- A -	
ARM, Pitch Control	1-2
- B -	
BEARING, Roller	1-1
BLADE, Moldboard	1-3
- C -	
CAP, Lock Pin	1-1
COVER, Housing	1-1
CUP, Bearing	1-1
- E -	
EYE, Pitch Control Clevis	1-2
- F -	
FRAME ASSEMBLY	1-1
- H -	
HANDLE, Lock Pin	1-1
- L -	
LEVER, Control	1-1
LEVER, Rear Lock Pin Lift	1-1
LINK ASSEMBLY, Pitch Control	1-2
- M -	
MOLDBOARD and BLADE ASSEMBLY	1-3
MOUNTING and PIVOT SHAFT	1-3
- N -	
NUT, Pivot Shaft Lock	1-3
- P -	
PIN, Clevis	{ 1-1
	{ 1-2
PIN, Lock	1-1
PIN, Tractor Hitch Link	1-2
- S -	
SCREW, Pitch Control Adjusting	1-2
SEAL, Oil	1-1
SPRING, Lock Pin	1-1
- T -	
TUBE, Pitch Control	1-2
- Y -	
YOKE, Main Frame	1-2

DANUSER *All Purpose Blade*

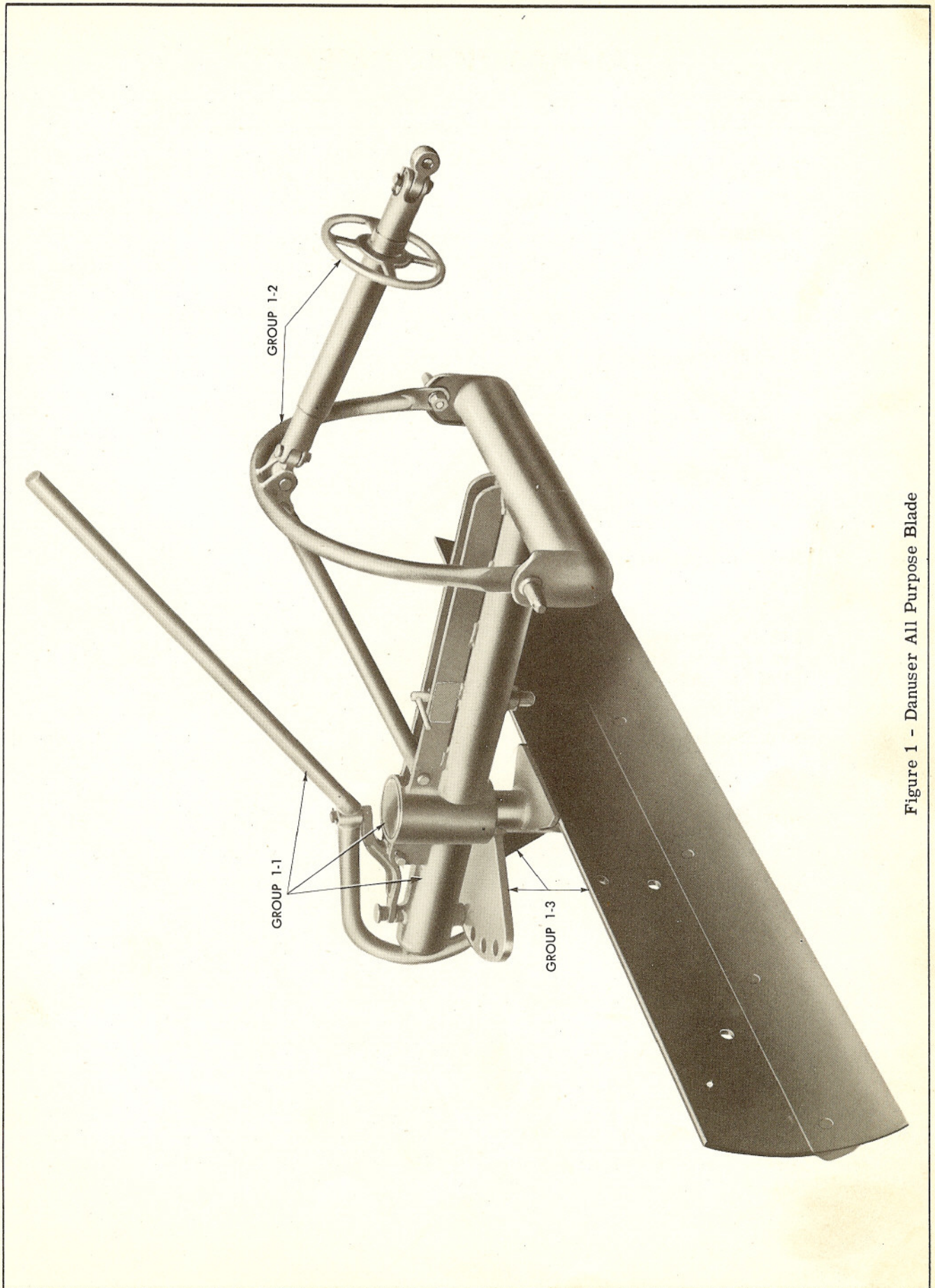

Figure 1 - Danuser All Purpose Blade

DANUSER *All Purpose Blade*

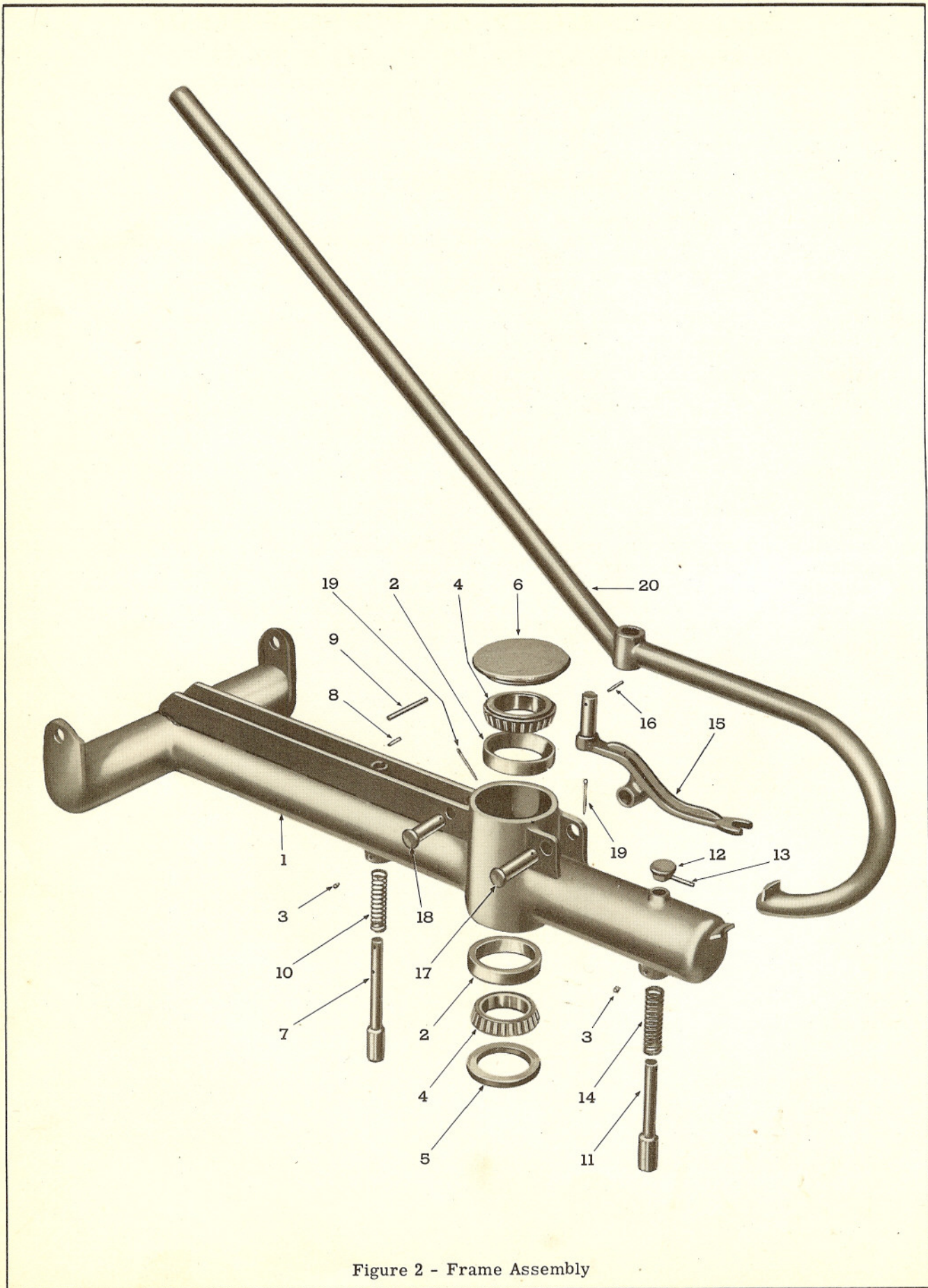

Figure 2 - Frame Assembly

DANUSER *All Purpose Blade*

Group 1--DANUSER ALL PURPOSE BLADE Models 19-16, 19-34, 19-50 & 19-51

FIG. 2	PART NO.	NAME AND DESCRIPTION	QTY. REQ.
		Group 1-1—FRAME ASSEMBLY	
1	190000 191370	FRAME ASSEMBLY. <i>(WITH BEARING CUPS)</i>	1
		Consists of Welded Frame which is not serviced separately plus Cup listed below:	
2	191039	CUP, Bearing	2
3	300332	FITTING, Lube	2
4	191040	CONE, Bearing	2
5	191038	SEAL, Oil	1
6	191056	COVER, Housing	1
7	191048	PIN, Lock, 3/4" x 1-1/8" x 8-11/16" (Front)	1
8	72537-S	PIN, Straight, 1/4" x 1-1/2" - Lock Pin	1
9	191046	HANDLE, Lock Pin, 3/8" x 4"	1
10	191045	SPRING, Lock Pin	1
11	191042	PIN, Lock, 3/4" x 1-1/8" x 7-1/4" (Rear)	1
12	191044	CAP, Lock Pin	1
13	72537-S	PIN, Straight, 1/4" x 1-1/2"	1
14	191043	SPRING, Lock Pin	1
15	191057	LEVER, Lift, Rear Lock Pin	1
16	72055-S	COTTER PIN, 3/16" x 1-1/4" - Lift Lever	1
17	191023	PIN, Clevis, 7/8" x 3-7/16" - Lift Lever	1
18	221224	PIN, Clevis, 3/4" x 2-3/4" - Control Arm	1
19	72055-S	COTTER PIN, 3/16" x 1-1/4" - Clevis Pin	2
20	191014	LEVER, Control (Prior to Serial No. 5034)	1
--	193671	LEVER, Control (After Serial No. 5033)	1

DANUSER *All Purpose Blade*

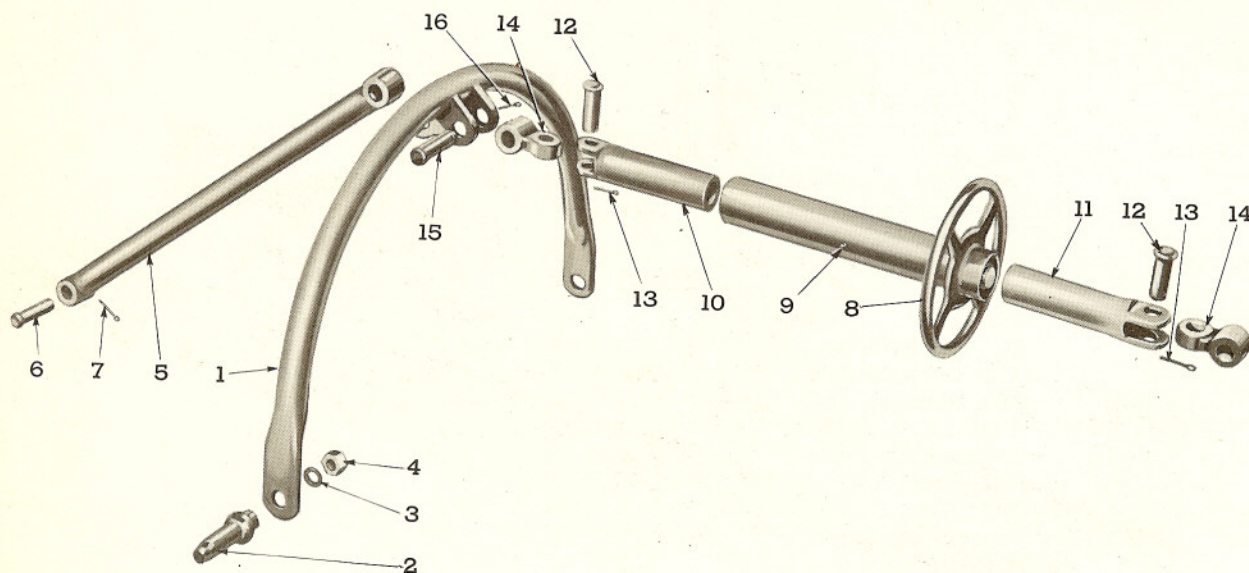

Figure 3 - Pitch Control Assembly

FIG. 3	PART NO.	NAME AND DESCRIPTION	QTY. REQ.
Group 1-2—PITCH CONTROL ASSEMBLY			
1	192303	YOKE, Main Frame (Welded Assembly) 104082	1
2	131010	PIN, Link, 4-1/2" - Tractor Hitch.	2
3	34831-S	LOCKWASHER, 5/8" } Link Pin	2
4	33806-S	NUT, 5/8" - 18 Hex. }	
5	192305	ARM, Pitch Control - Yoke to Frame.	1
6	221224	PIN, Clevis, 3/4" x 2-3/4" - Control Arm	2
7	72055-S	COTTER PIN, 3/16" x 1-1/4" - Clevis Pin.	2
-	192570	LINK ASSEMBLY, Pitch Control.	1
Consists of:			
8	192571*	SCREW, Adjusting (Welded Assembly)	1
9	300332	FITTING, Lube	1
10	192575	TUBE, Pitch Control (Right Hand Thread).	1
11	192576	TUBE, Pitch Control (Left Hand Thread)	1
12	191001	PIN, Clevis, 3/4" x 2-7/32" - Tube to Eye	2
13	72055-S	COTTER PIN, 3/16" x 1-1/4" - Clevis Pin.	2
14	191000	EYE, Clevis, Pitch Control	2
15	221224	PIN, Clevis, 3/4" x 2-3/4" - Clevis Eye.	1
16	72055-S	COTTER PIN, 3/16" x 1-1/4" - Clevis Pin.	1
NOTE:			
*Effective on Serial #9800, prior to the above, the following adjusting screw was used:			
--	191007	SCREW ADJUSTING (Welded Assembly).	1

DANUSER *All Purpose Blade*

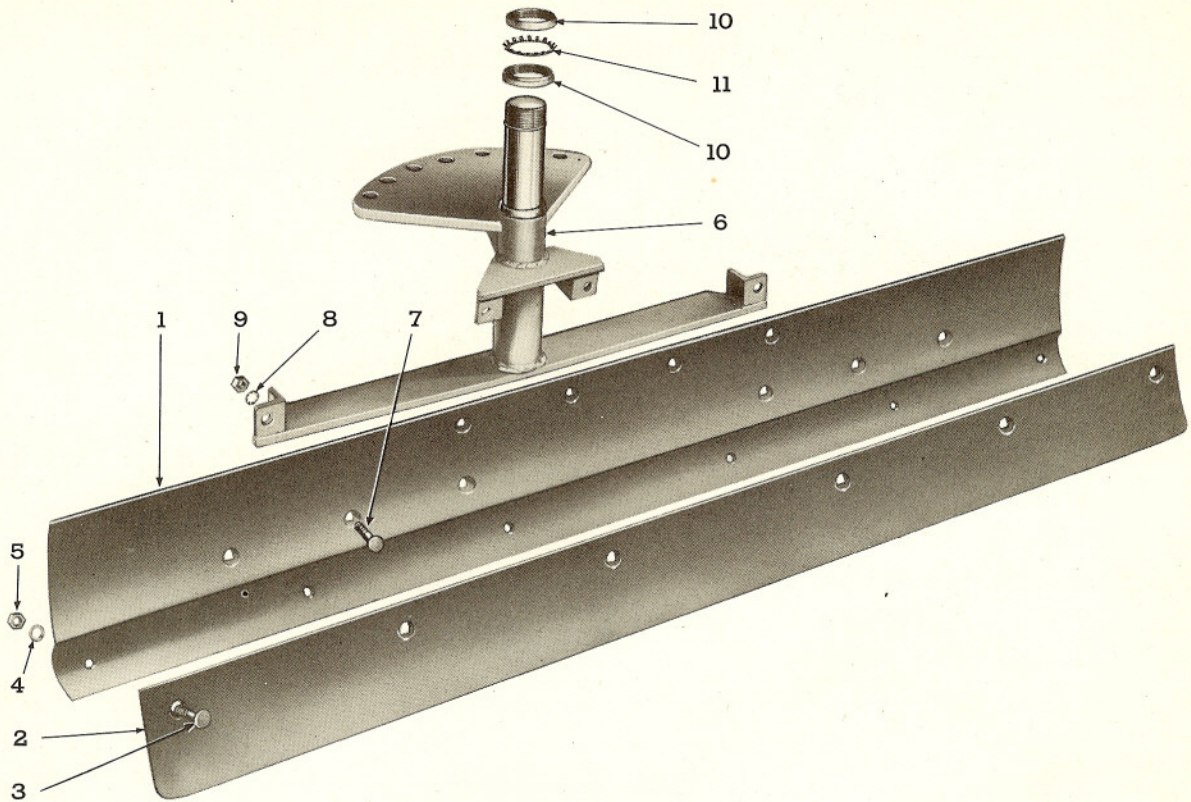

Figure 4 - Moldboard and Blade Assembly

FIG. 4	PART NO.	NAME AND DESCRIPTION	QTY. REQ.
Group 1-3—MOLDBOARD AND BLADE ASSEMBLY			
1	191035	MOLDBOARD and BLADE ASSEMBLY 6 ft. (For Models 19-16 & 19-50) . . .	1
-	191380	MOLDBOARD and BLADE ASSEMBLY 8 ft. (For Models 19-34 & 19-51) . . .	1
Consists of Moldboard which is not serviced separately plus items listed below:			
2	191037	BLADE, Moldboard, 6 ft.	1
-	191381	BLADE, Moldboard, 8 ft.	1
3	300308	BOLT, 1/2" - 13 x 1-1/2" Flat Hd. Sq. Nk. } Blade to 6 ft. Blade	6
4	34809-S	LOCKWASHER, 1/2" } Moldboard 8 ft. Blade	8
5	33845-S	NUT, 1/2" - 13	
6	191025	MOUNTING and PIVOT SHAFT (Welded Assembly) 7 Hole Adjustment.	1
-	194001	MOUNTING and PIVOT SHAFT (Welded Assembly) 9 Hole Adjustment.	1
7	300308	BOLT, 1/2" - 13 x 1-1/2" Flat Hd. Sq. Nk. } Moldboard to Mounting.	4
8	34809-S	LOCKWASHER, 1/2"	
9	33845-S	NUT, 1/2" - 13 Hex.	
10	191055	NUT, Lock, 2-9/16" - 18 (Special)	2
11	191054	LOCKWASHER, 2-9/16", External Tooth (Special)	1

NUMERICAL INDEX

Part No.	Part Name	Page No.
131010	Pin	8
190980	Frame Assembly	7
191000	Eye	8
191001	Pin	8
191007	Screw.	8
191011	Arm.	8
191014	Lever.	7
191023	Pin	7
191025	Mounting and Pivot Shaft	9
191035	Moldboard and Blade Assembly.	9
191037	Blade.	9
191038	Seal.	7
191039	Cup	7
191040	Cone	7
191042	Pin	7
191043	Spring	7
191044	Cap	7
191045	Spring	7
191046	Handle	7
191048	Pin	7
191054	Lockwasher.	11
191055	Nut	11
191056	Cover.	7
191057	Lever.	7
191380	Moldboard & Blade Assembly.	9
191381	Moldboard & Blade Assembly.	9
192303	Yoke	8
192570	Link Assembly.	8
192571	Screw.	8
192575	Tube	8
192576	Tube	8
193671	Lever.	7
194001	Mounting & Pivot Shaft	9
221224	Pin	7-8
300308	Bolt.	9
300332	Fitting	7-8